

JV100004

Ductile Iron NBR Lined Butterfly Valve Lugged & Tapped Type PN16



Economical general purpose valve with an NBR (Buna) liner, offering a long life with low maintenance. Self-lubricating bearings ensures perfect guiding and turning of the shaft without seizure or premature wear.

The butterfly valve offers quick opening and closing with full flow in either direction and leak tight shut off.

Flange gaskets not needed since the lining that extends onto the faces acts as a gasket.

Approvals, Features & Benefits

- NBR lined for oil duties
- Lightweight construction
- Bubble-tight sealing
- Epoxy coated body
- ISO 5211 top for direct mount actuation
- Lever operated as standard (25-250mm)
- Gearbox operated as standard (300-600mm)

Pressure & Temperature

Pressure range :-
25-300mm: 16 Bar
350-600mm: 10 Bar

Temperature range :-
-10°C to 80°C

DN	40	50	65	80	100	125	150	200	250
A	33	43	46	46	52	56	56	60	68
B	116	126	136	150	170	180	200	230	266
C	63	62	69	90	106	119	131	166	202
E	170	170	170	206	206	285	285	400	530
F	50	50	50	69	69	90	90	72	72
PCD	110	125	145	160	180	210	240	295	355
n° x M	4 x M16	4 x M16	4 x M16	8 x M16	8 x M16	8 x M16	8 x M20	12 x M20	12 x M24
ISO 5211	F05	F05	F05	F05	F05	F07	F07	F10	F12
Torque (Nm)*	11.5	16.25	26.25	35	55	85	123.75	202.5	321.25
Weight Kg	2.3	3.2	4.1	5.4	6.7	9.6	10.8	21.1	32.7

DN	300	350	400	450	500	600
A	78	78	102	114	127	154
B	292	335	360	422	480	562
C	235	257	292	318	355	444
L	190	190	190	183	311	386
L1	170	170	170	151	214	262
F2	226	226	226	216	256	285
ØO	300	300	300	285	285	385
PCD	410	470	525	585	650	770
n° x M	12 x M24	16 x M24	16 x M24	20 x M24	20 x M24	20 x M27
ISO 5211	F12	F12	F14	F14	F14	F16
Torque (Nm)*	458.75	687.5	1062.5	1928.75	2640	4418.75
Weight Kg	41.2	79.3	122.6	154.8	228.3	308.6

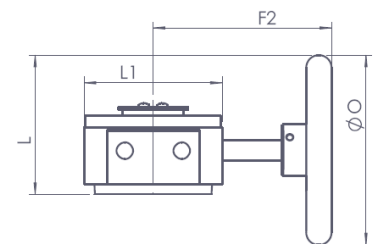

* Torque calculated at 16 Bar wet duty, pressure includes 25% safety, add 25% for dry duty.

MATERIALS

Body	Ductile Iron (Epoxy Coated)
Disc	Stainless Steel (CF8M)
Liner	NBR
Shaft	Stainless Steel (AISI 420)